

Wizardry: Proving Grounds of the Mad Overlord

Proving Grounds Level 1

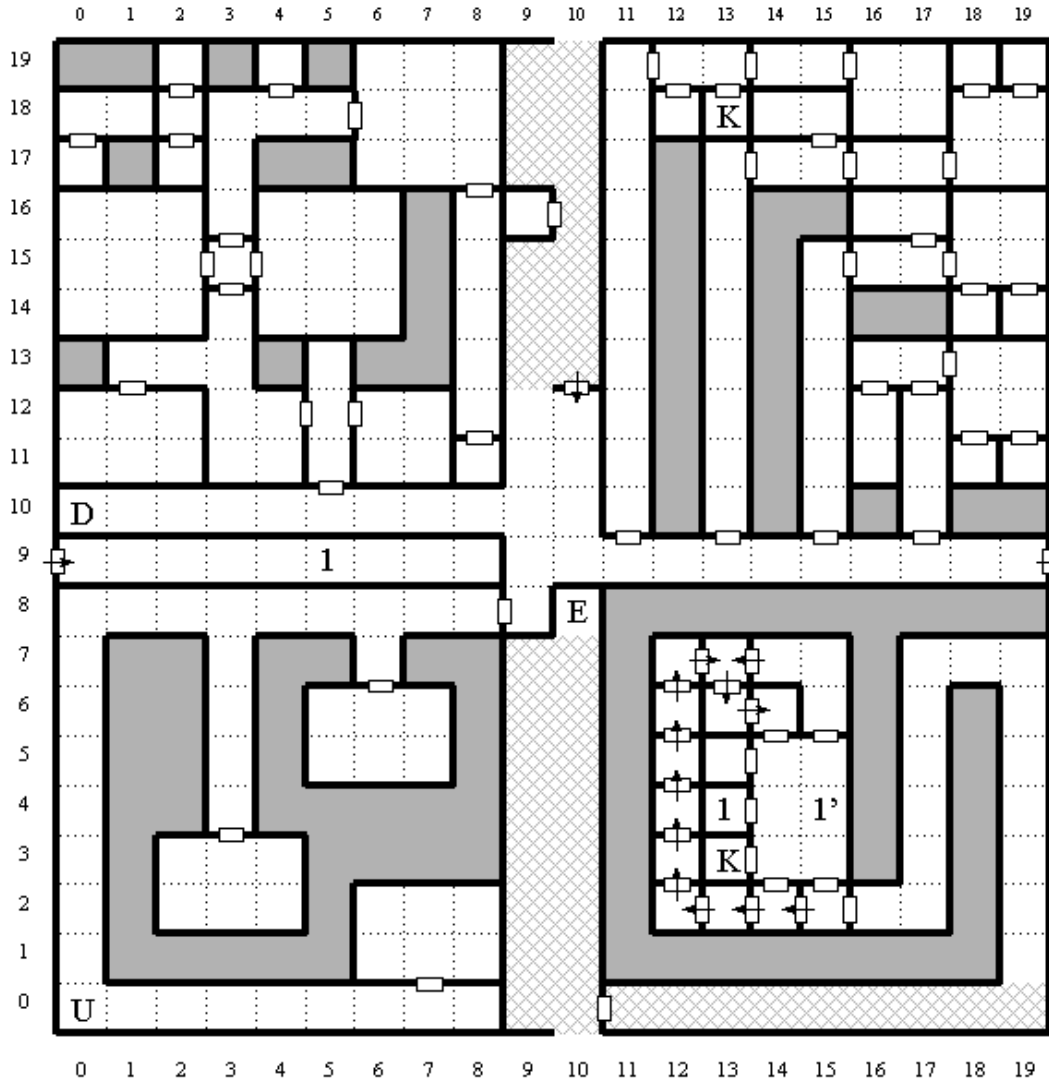

Floor: 1

- Marks**
- K : Key Item
 - E : Elevator
 - P : Pit
 - D : Down Stair
 - U : Up Stair
 - X,X' : Warp X → X'
 - T : Turn Table
 - S : Shoot
- Parts**
- Wall
 - Door
 - One Way Door
 - Wall
 - Dark

Proving Grounds Level 2

Wizardry

Floor: 2

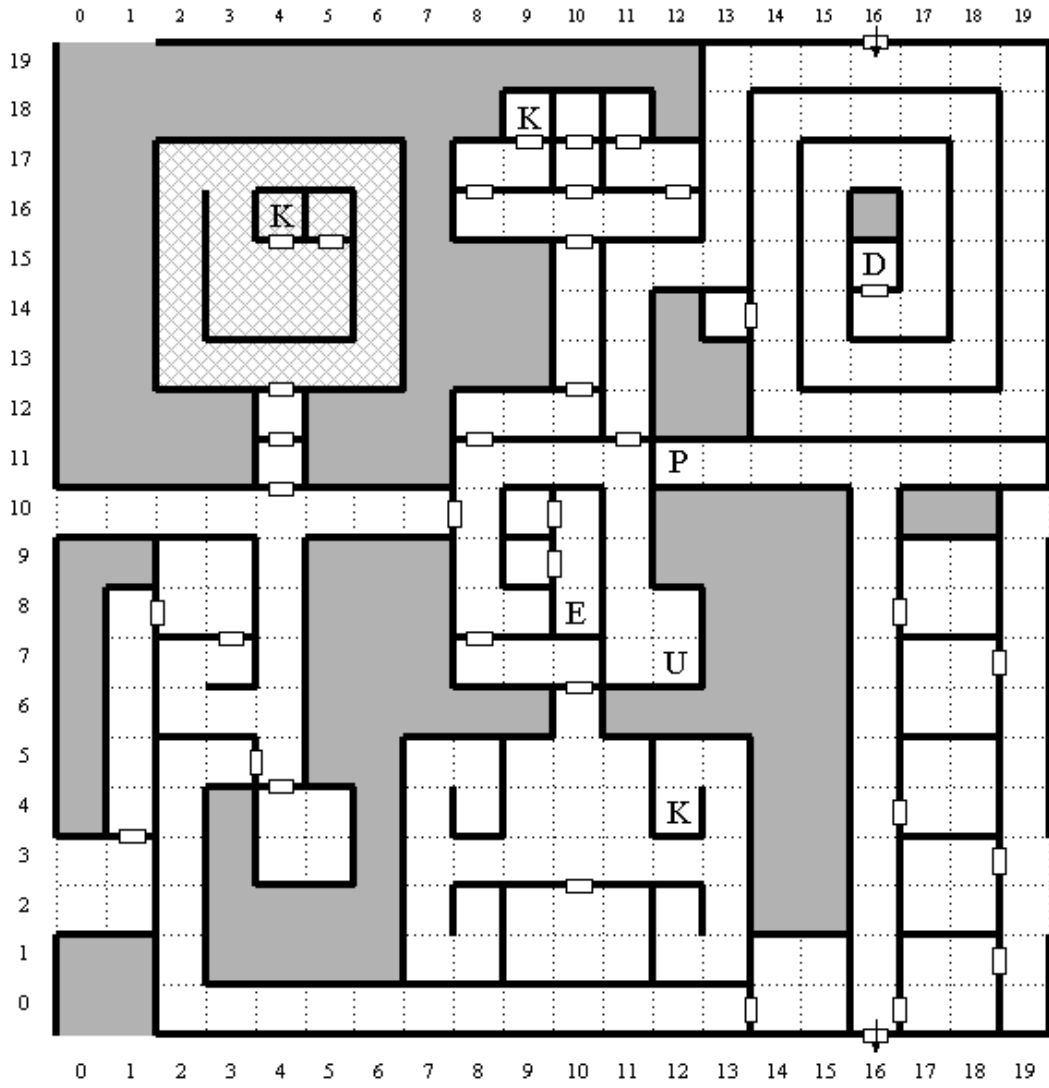

Marks

- K : Key Item
- E : Elevator
- P : Pit
- D : Down Stair
- U : Up Stair
- X,X' : Warp X → X'
- T : Turn Table
- S : Shoot

Parts

- Wall
- Door
- One Way Door
- Wall
- Dark

Wizardry

Proving Grounds Level 3



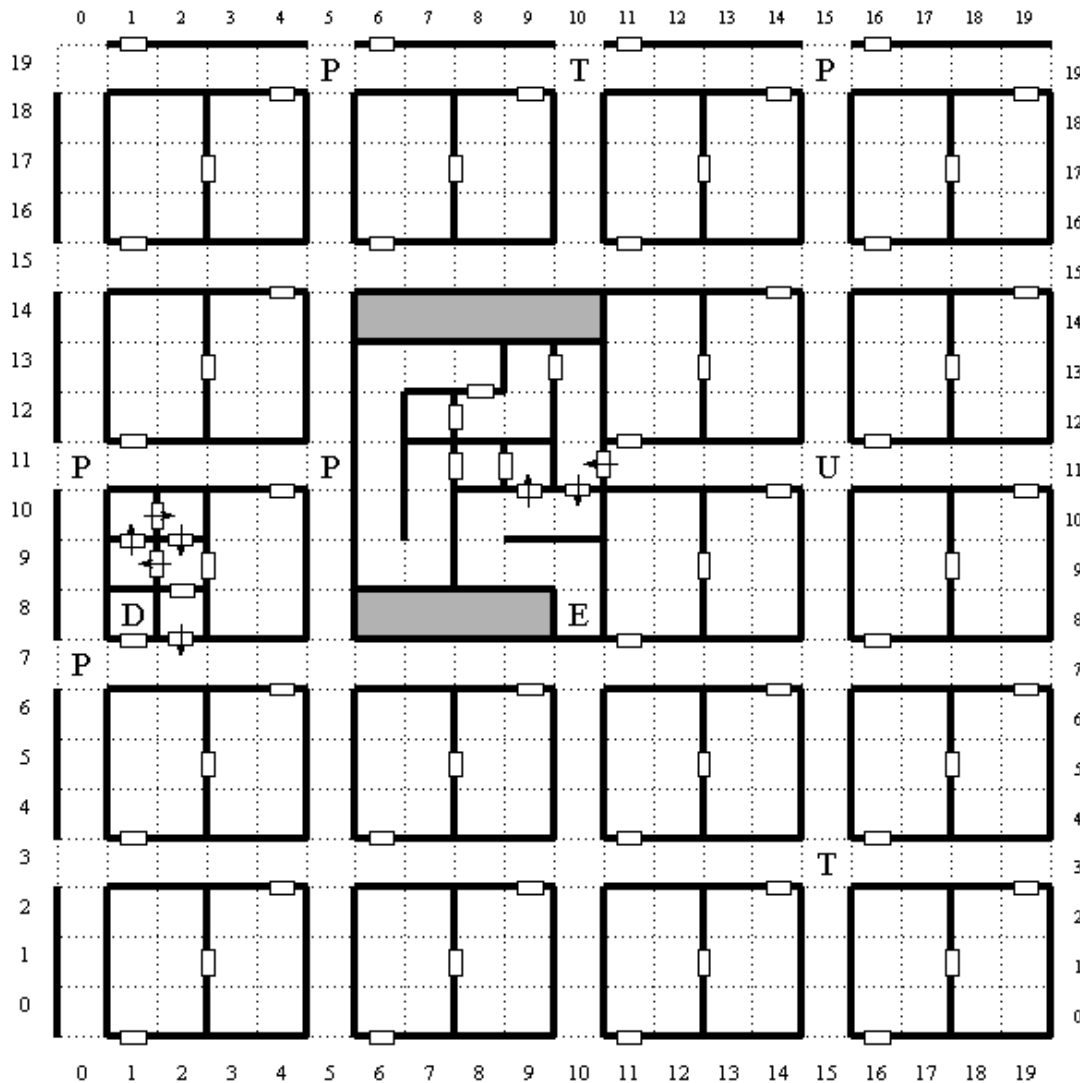

Floor: 3



Marks

- K : Key Item
- E : Elevator
- P : Pit
- D : Down Stair
- U : Up Stair
- X,X' : Warp X → X'
- T : Turn Table
- S : Shoot

Parts

-  Wall
-  Door
-  One Way Door
-  Wall
-  Dark

Wizardry

Proving Ground Level 4

Floor: 4

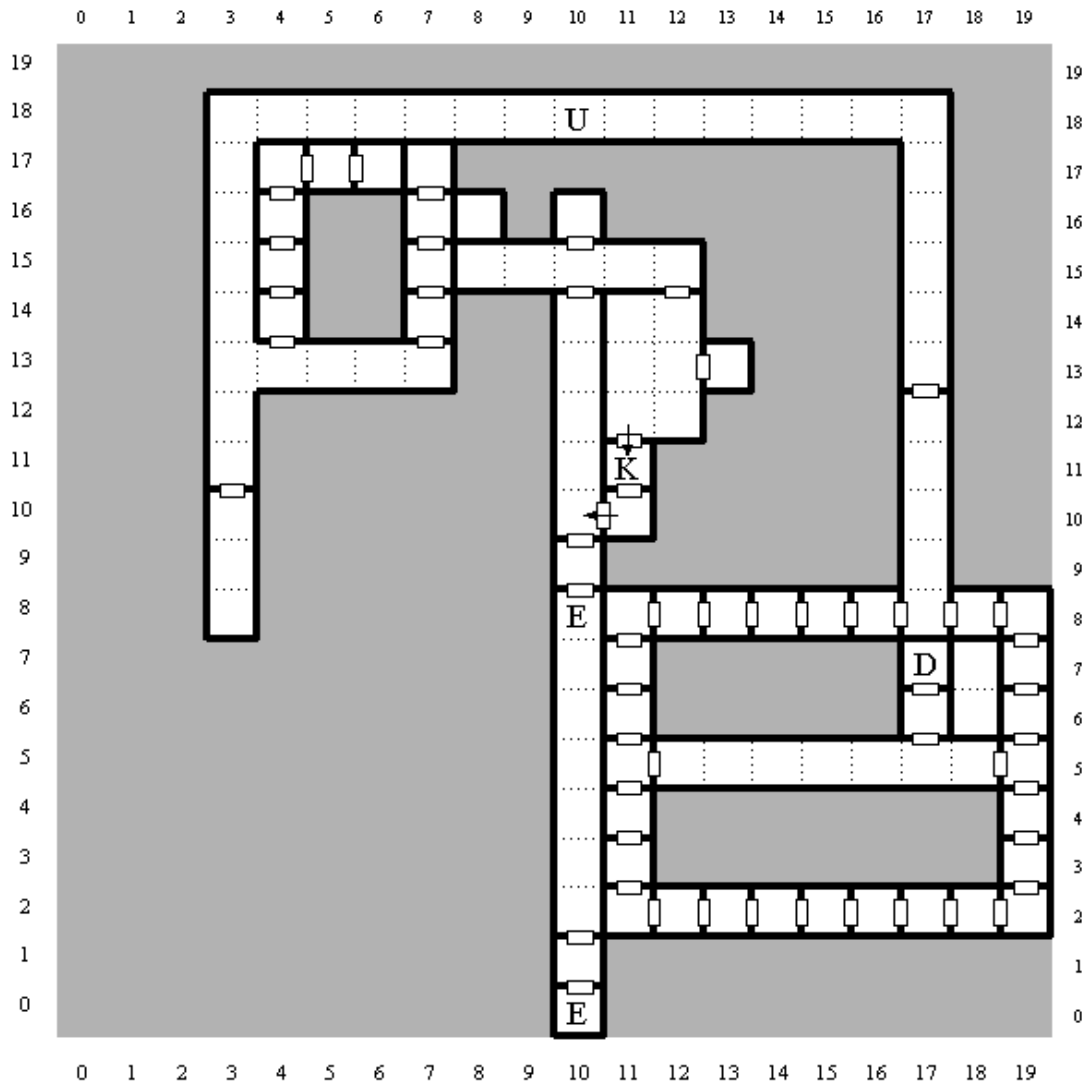

Marks

- K : Key Item
- E : Elevator
- P : Pit
- D : Down Stair
- U : Up Stair
- X, X' : Warp X → X'
- T : Turn Table
- S : Shoot

Parts

- Wall
- Door
- One Way Door
- Wall
- Dark

Proving Ground Level 5

Wizardry



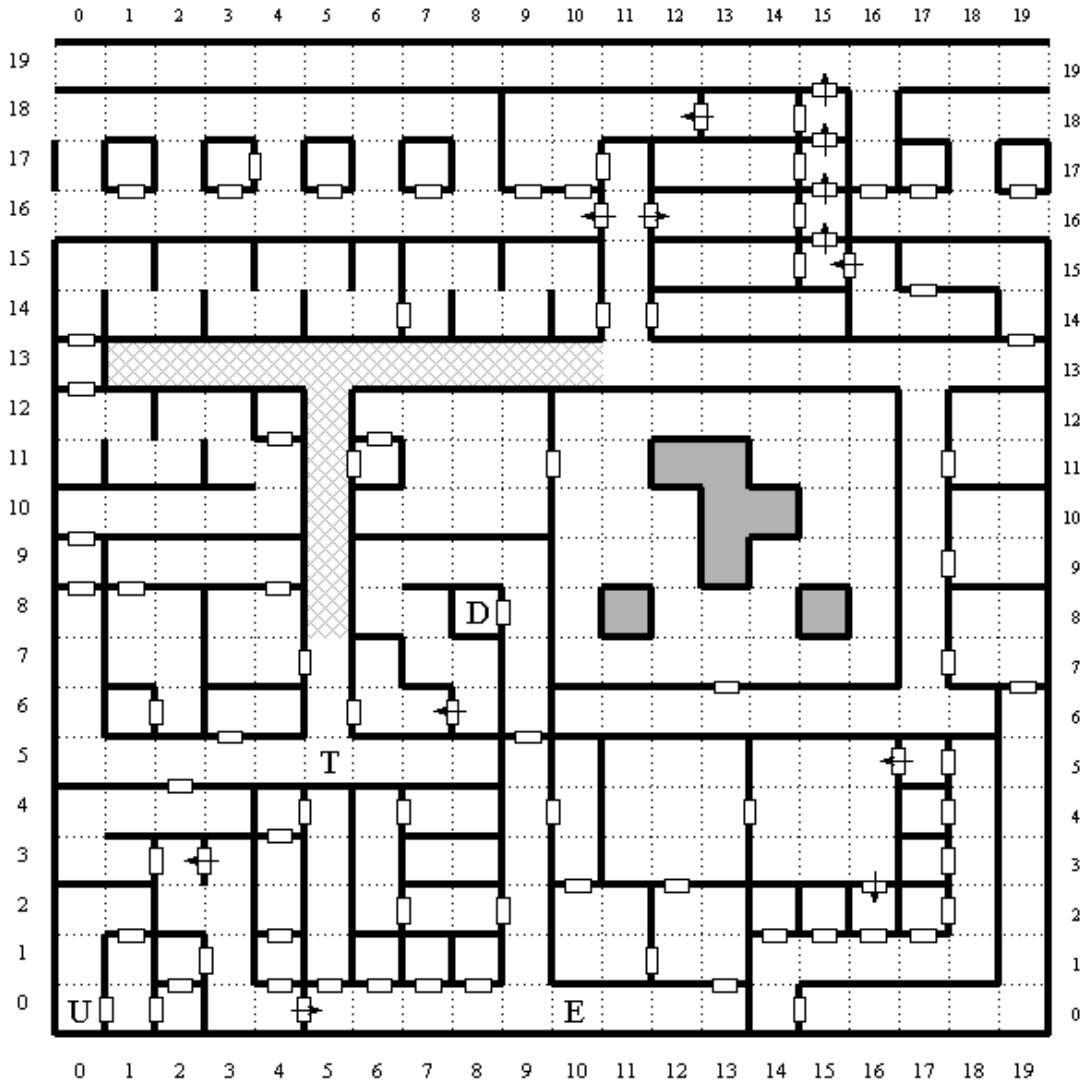

Floor: 5



Marks

- K : Key Item
- E : Elevator
- P : Pit
- D : Down Stair
- U : Up Stair
- X,X' : Warp X → X'
- T : Turn Table
- S : Shoot

Parts

-  Wall
-  Door
-  One Way Door
-  Wall
-  Dark

Wizardry

Proving Ground Level 6

Floor: 6

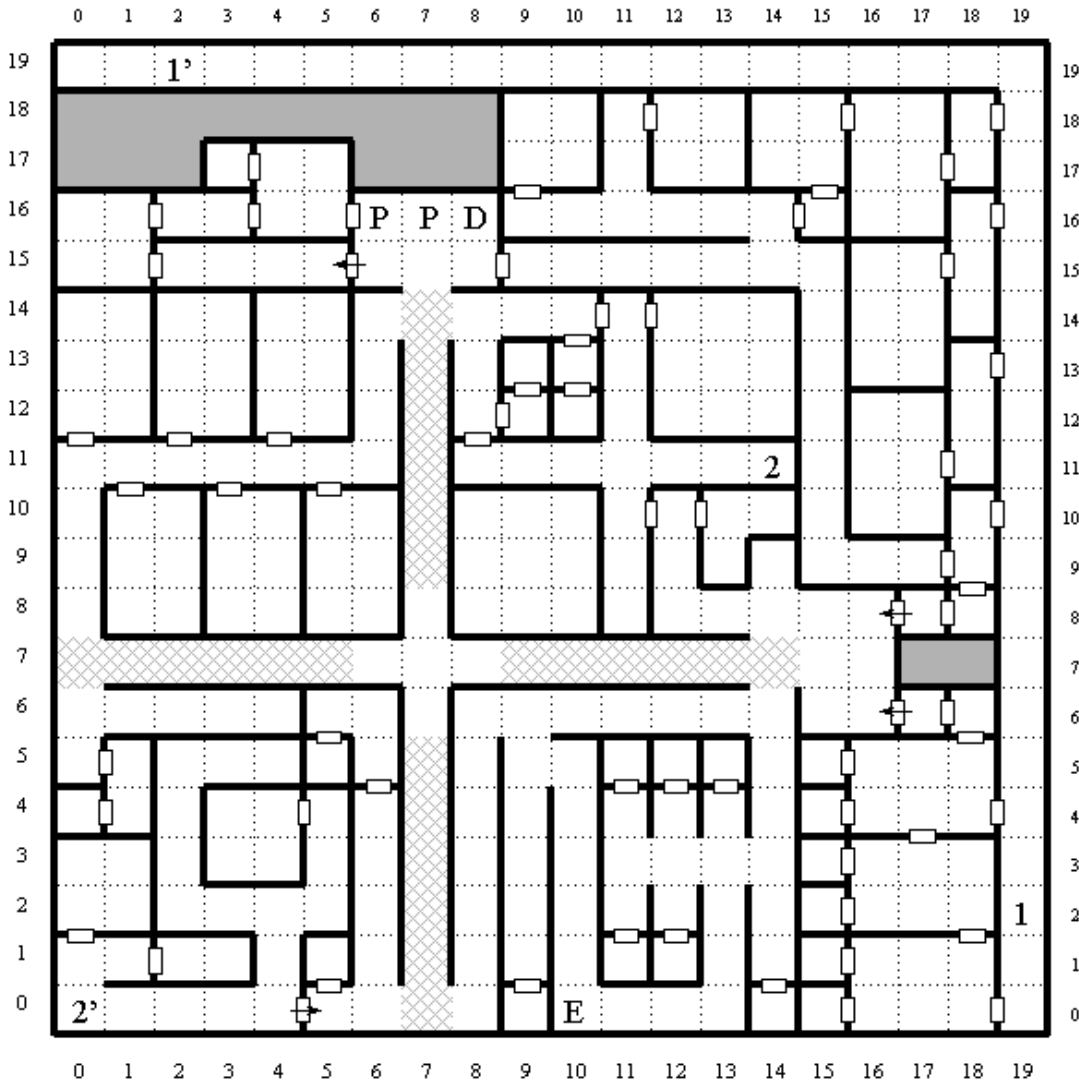

Marks

- K : Key Item
- E : Elevator
- P : Pit
- D : Down Stair
- U : Up Stair
- X,X' : Warp X → X'
- T : Turn Table
- S : Shoot

Parts

- Wall
- Door
- One Way Door
- Wall
- Dark

Wizardry

Proving Ground Level 7

Floor: **8**

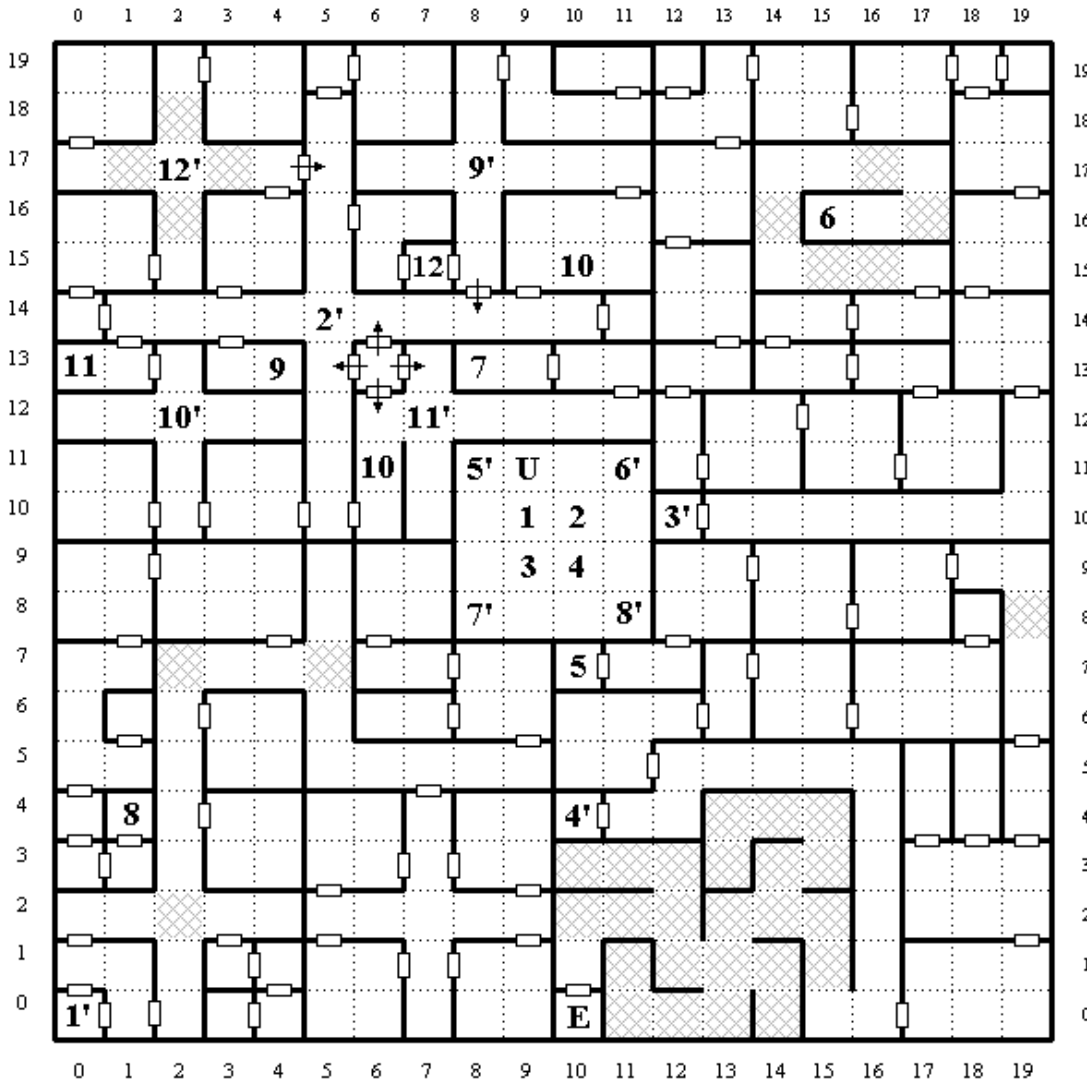

Marks

- K : Key Item
- E : Elevator
- P : Pit
- D : Down Stair
- U : Up Stair
- X,X' : Warp X → X'
- T : Turn Table
- S : Shoot

Parts

- Wall
- Door
- One Way Door
- Dark

Wizardry

Proving Ground Level 9

Floor: 9

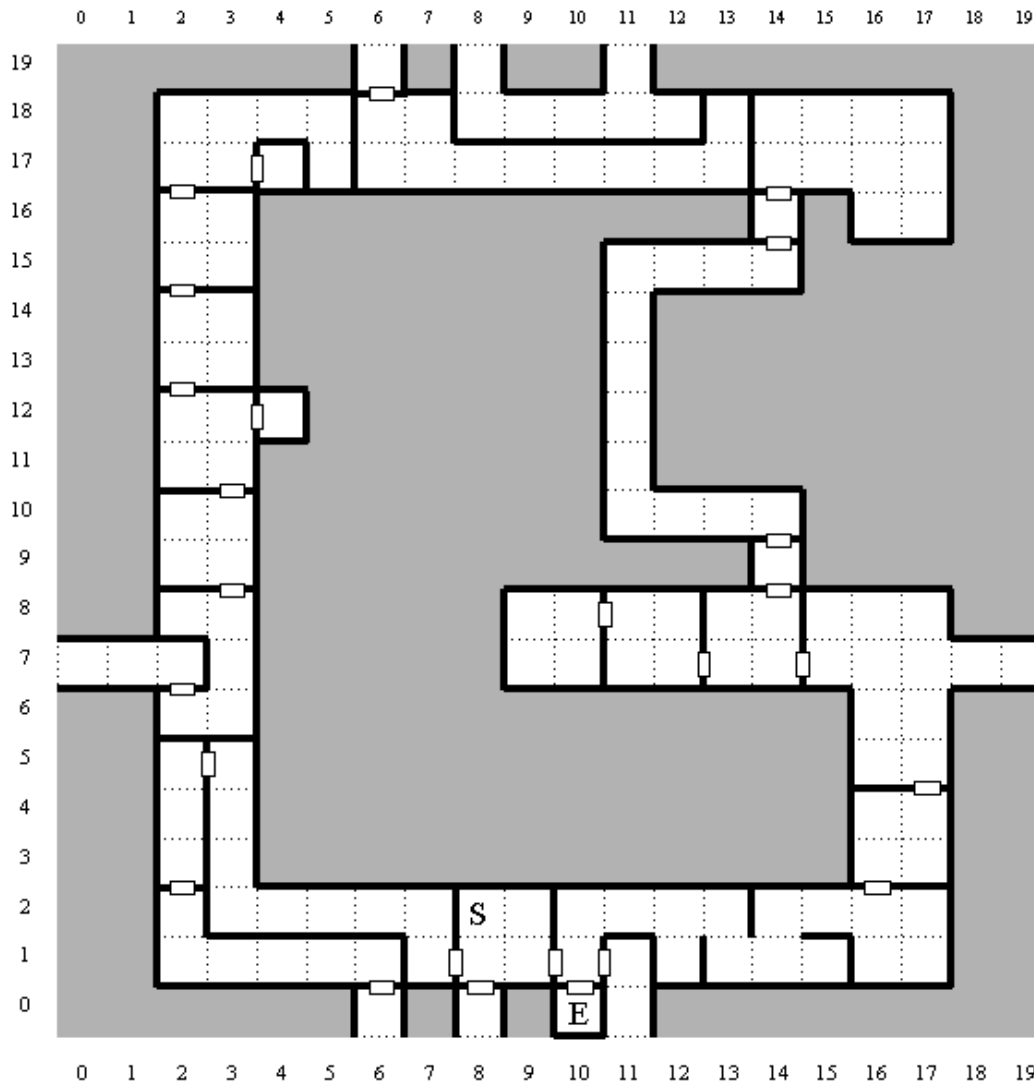

Marks

- K : Key Item
- E : Elevator
- P : Pit
- D : Down Stair
- U : Up Stair
- X,X' : Warp X → X'
- T : Turn Table
- S : Shoot

Parts

- Wall
- Door
- One Way Door
- Wall
- Dark

Wizardry

Proving Grounds Level 10

Floor: 10

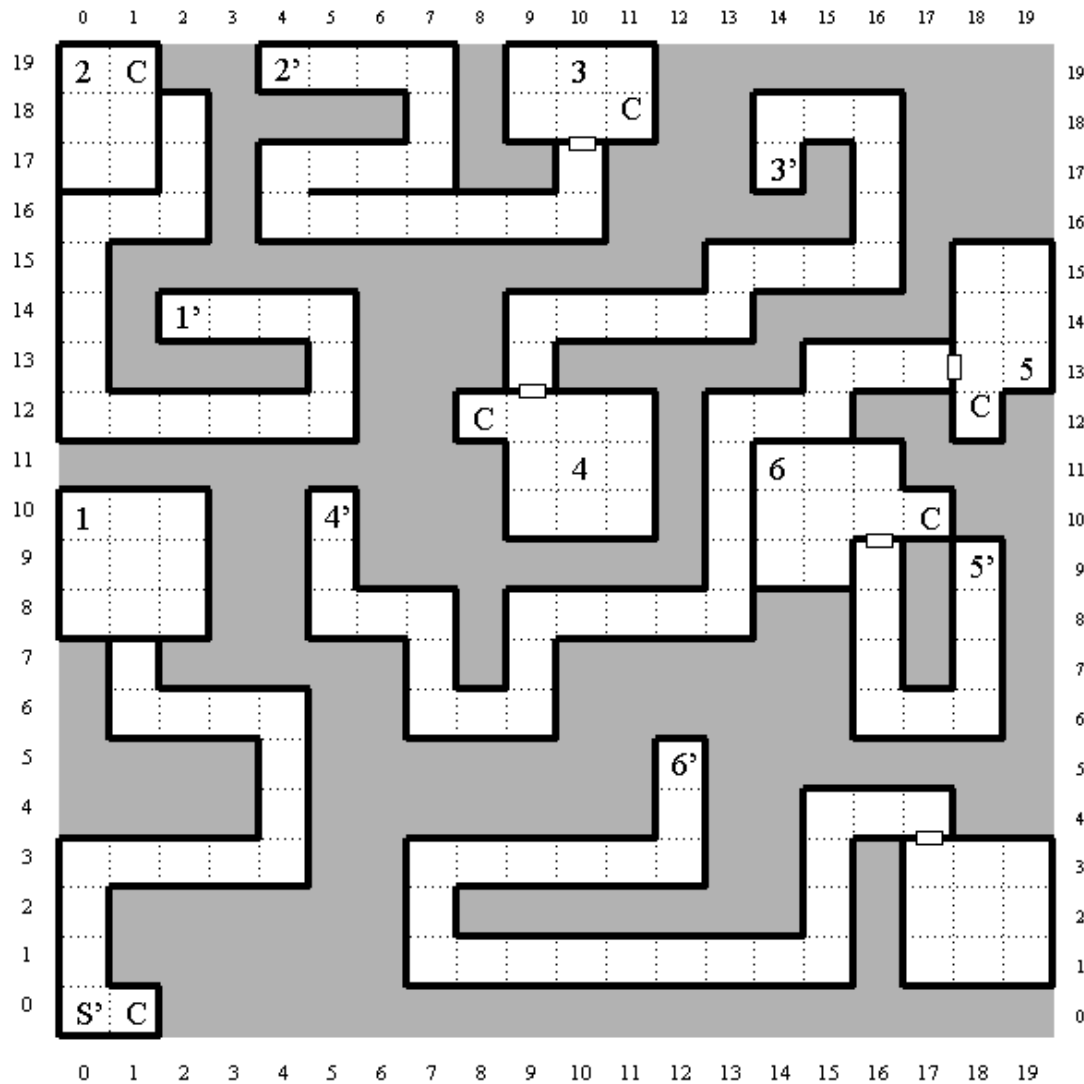

Marks

- K : Key Item
- E : Elevator
- P : Pit
- D : Down Stair
- U : Up Stair
- X,X' : Warp X → X'
- T : Turn Table
- S : Shoot

Parts

- Wall
- Door
- One Way Door
- Dark

Wizardry

(c) Copyright by Jim Hayes.